

- 1
- 2
- 3
- 4
- 5
- 6
- 7
- 8
- 9
- 10
- 11
- 12
- 13
- 14
- 15
- 16
- 17
- 18

## ESECUZIONI STANDARD

- **GN 732.1-ST:** acciaio classe 5.8 (resistenza a trazione 500 N/mm<sup>2</sup>), cementato (spessore della tempra 0.2 ÷ 0.4 mm) e brunito.
- **GN 732.1-NI:** acciaio inox AISI 303

## CARATTERISTICHE E APPLICAZIONI

Le dimensioni d2 e l1 permettono l'impiego ottimale delle viti a colletto GN 732.1 in abbinamento alle viti a occhiello DIN 444 (vedi pag. 888), terminali a occhiello GN 444.2 (vedi pag. 889) e mozzi con camma eccentrica GN 919 (vedi pag. 946).

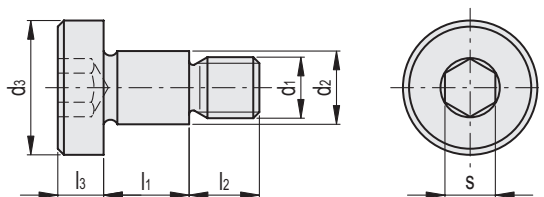
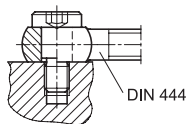

## GN 732.1-ST

Codice	Descrizione	d1	d2	d3	l1 +0.25 +0.13	l2	l3	s	⚖
GN.27771	GN 732.1-M5-6-5-ST	M5	6 -0.03/-0.05	12	5	7	3	3	4
GN.27772	GN 732.1-M5-6-6-ST	M5	6 -0.03/-0.05	12	6	7	3	3	4
GN.27944	GN 732.1-M5-6-7-ST	M5	6 -0.03/-0.05	12	7	7	3	3	5
GN.27773	GN 732.1-M5-6-8-ST	M5	6 -0.03/-0.05	12	8	7	3	3	5
GN.27776	GN 732.1-M6-8-5-ST	M6	8 -0.05/-0.08	14	5	8	4	4	8
GN.27775	GN 732.1-M6-8-6-ST	M6	8 -0.05/-0.08	14	6	8	4	4	8
GN.27777	GN 732.1-M6-8-8-ST	M6	8 -0.05/-0.08	14	8	8	4	4	9
GN.27955	GN 732.1-M6-8-9-ST	M6	8 -0.05/-0.08	14	9	8	4	4	9
GN.27778	GN 732.1-M6-8-10-ST	M6	8 -0.05/-0.08	14	10	8	4	4	10
GN.27958	GN 732.1-M6-8-12-ST	M6	8 -0.05/-0.08	14	12	8	4	4	10
GN.27960	GN 732.1-M6-8-13-ST	M6	8 -0.05/-0.08	14	13	8	4	4	8
GN.27966	GN 732.1-M8-10-8-ST	M8	10 -0.05/-0.08	16	8	11	5	5	14
GN.27781	GN 732.1-M8-10-10-ST	M8	10 -0.05/-0.08	16	10	11	5	5	17
GN.27782	GN 732.1-M8-10-12-ST	M8	10 -0.05/-0.08	16	12	11	5	5	18
GN.27970	GN 732.1-M8-10-14-ST	M8	10 -0.05/-0.08	16	14	11	5	5	19
GN.27972	GN 732.1-M8-10-15-ST	M8	10 -0.05/-0.08	16	15	11	5	5	18
GN.27786	GN 732.1-M10-12-12-ST	M10	12 -0.05/-0.08	19	12	13	6	6	29
GN.27787	GN 732.1-M10-12-14-ST	M10	12 -0.05/-0.08	19	14	13	6	6	30
GN.27979	GN 732.1-M10-12-16-ST	M10	12 -0.05/-0.08	19	16	13	6	6	32
GN.27981	GN 732.1-M10-12-17-ST	M10	12 -0.05/-0.08	19	17	13	6	6	35
GN.27791	GN 732.1-M12-14-14-ST	M12	14 -0.05/-0.08	22	14	16	8	8	49
GN.27792	GN 732.1-M12-14-16-ST	M12	14 -0.05/-0.08	22	16	16	8	8	51
GN.27989	GN 732.1-M12-14-18-ST	M12	14 -0.05/-0.08	22	18	16	8	8	53
GN.27991	GN 732.1-M14-16-17-ST	M14	16 -0.05/-0.08	25	17	19	8	8	71
GN.27993	GN 732.1-M14-16-18-ST	M14	16 -0.05/-0.08	25	18	19	8	8	73

Elementi meccanici

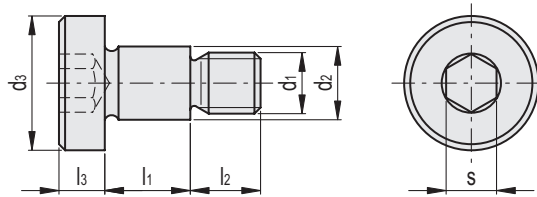

## GN 732.1-NI

INOX STAINLESS STEEL

Codice	Descrizione	d1	d2	d3	l1 +0.25 +0.13	l2	l3	s	⚖
GN.27941	GN 732.1-M5-6-5-NI	M5	6 -0.03/-0.05	12	5	7	3	3	4
GN.27942	GN 732.1-M5-6-6-NI	M5	6 -0.03/-0.05	12	6	7	3	3	4
GN.27943	GN 732.1-M5-6-7-NI	M5	6 -0.03/-0.05	12	7	7	3	3	5
GN.27945	GN 732.1-M5-6-8-NI	M5	6 -0.03/-0.05	12	8	7	3	3	5
GN.27951	GN 732.1-M6-8-5-NI	M6	8 -0.05/-0.08	14	5	8	4	4	7
GN.27952	GN 732.1-M6-8-6-NI	M6	8 -0.05/-0.08	14	6	8	4	4	9
GN.27953	GN 732.1-M6-8-8-NI	M6	8 -0.05/-0.08	14	8	8	4	4	9
GN.27954	GN 732.1-M6-8-9-NI	M6	8 -0.05/-0.08	14	9	8	4	4	9
GN.27956	GN 732.1-M6-8-10-NI	M6	8 -0.05/-0.08	14	10	8	4	4	9
GN.27957	GN 732.1-M6-8-12-NI	M6	8 -0.05/-0.08	14	12	8	4	4	10
GN.27959	GN 732.1-M6-8-13-NI	M6	8 -0.05/-0.08	14	13	8	4	4	9
GN.27965	GN 732.1-M8-10-8-NI	M8	10 -0.05/-0.08	16	8	11	5	5	15
GN.27967	GN 732.1-M8-10-10-NI	M8	10 -0.05/-0.08	16	10	11	5	5	16
GN.27968	GN 732.1-M8-10-12-NI	M8	10 -0.05/-0.08	16	12	11	5	5	18
GN.27969	GN 732.1-M8-10-14-NI	M8	10 -0.05/-0.08	16	14	11	5	5	19
GN.27971	GN 732.1-M8-10-15-NI	M8	10 -0.05/-0.08	16	15	11	5	5	19
GN.27976	GN 732.1-M10-12-12-NI	M10	12 -0.05/-0.08	19	12	13	6	6	28
GN.27977	GN 732.1-M10-12-14-NI	M10	12 -0.05/-0.08	19	14	13	6	6	30
GN.27978	GN 732.1-M10-12-16-NI	M10	12 -0.05/-0.08	19	16	13	6	6	31
GN.27980	GN 732.1-M10-12-17-NI	M10	12 -0.05/-0.08	19	17	13	6	6	32
GN.27986	GN 732.1-M12-14-14-NI	M12	14 -0.05/-0.08	22	14	16	8	8	50
GN.27987	GN 732.1-M12-14-16-NI	M12	14 -0.05/-0.08	22	16	16	8	8	51
GN.27988	GN 732.1-M12-14-18-NI	M12	14 -0.05/-0.08	22	18	16	8	8	53
GN.27990	GN 732.1-M14-16-17-NI	M14	16 -0.05/-0.08	25	17	19	8	8	71
GN.27992	GN 732.1-M14-16-18-NI	M14	16 -0.05/-0.08	25	18	19	8	8	73

